

Mildred Lake

Page 1: AIS Monitoring and Water
 Clarity Report of July 29, 2015



Land & Water Conservation Department

*Jean Hansen, County Conservationist
Michele Sadauskas, AIS Coordinator
Jonna Stephens Jewell, Program Assistant*

Oneida County Courthouse
P O Box 400, Rhinelander, Wisconsin 54501
Phone (715) 369-7835 Fax (715) 369-6268

Mildred Lake AIS Monitoring and Water Clarity Report

WBIC: 1004600
Previous AIS Findings: Chinese Mystery Snails
New AIS Findings: None
Field Date: July 29, 2015
Field Crew: Stephanie Boismenu and Samantha Zommers, AIS Project Assistants, Oneida County Land and Water Conservation Department
Report By: Samantha Zommers

Stephanie and I monitored Mildred Lake on July 29, 2015. We went out on the lake with Connie, who is vice president of the Lake Mildred Property Owners Association. Since this lake is 168 acres, it is large for our AIS team to do by canoe. Due to the unavailability of the dissolved oxygen meter along with windy weather conditions, we were not able to obtain information on dissolved oxygen, temperature, and Secchi disk reading at the deep hole. Although we did not obtain deep hole readings, being up high in a boat allowed us to do a great visual search of the lakes aquatic and terrestrial plants while looking for invasive species.

Mildred Lake is in the municipality of Newbold (Figure 1). This lake is a seepage lake with an oligotrophic state with a maximum depth of 45 feet (Figures 2a and 2b). Oligotrophic lakes are characterized by a low amount of nutrients, limited amount of plants and algae, and often have increased dissolved oxygen levels. The WDNR lists Mildred Lake's substrates as 65% sand, 10% gravel, 20% rock, and 5% muck. The majority of the fish present in this lake are largemouth bass and panfish. There are also musky and walleye present.

We entered Mildred Lake via Connie's dock. Using her boat we did five in-depth presence/absence checks for aquatic invasive species (Figure 3). We chose to inspect public and private boat landings and private docks because they have a higher risk of having invasive species. In addition to the five presence/absence checks, we also visually inspected the entire shoreline of the lake.

Findings:

Aquatic Invasive Species:

No new discoveries.

Dissolved Oxygen:

No data available.

Secchi:

No data available.

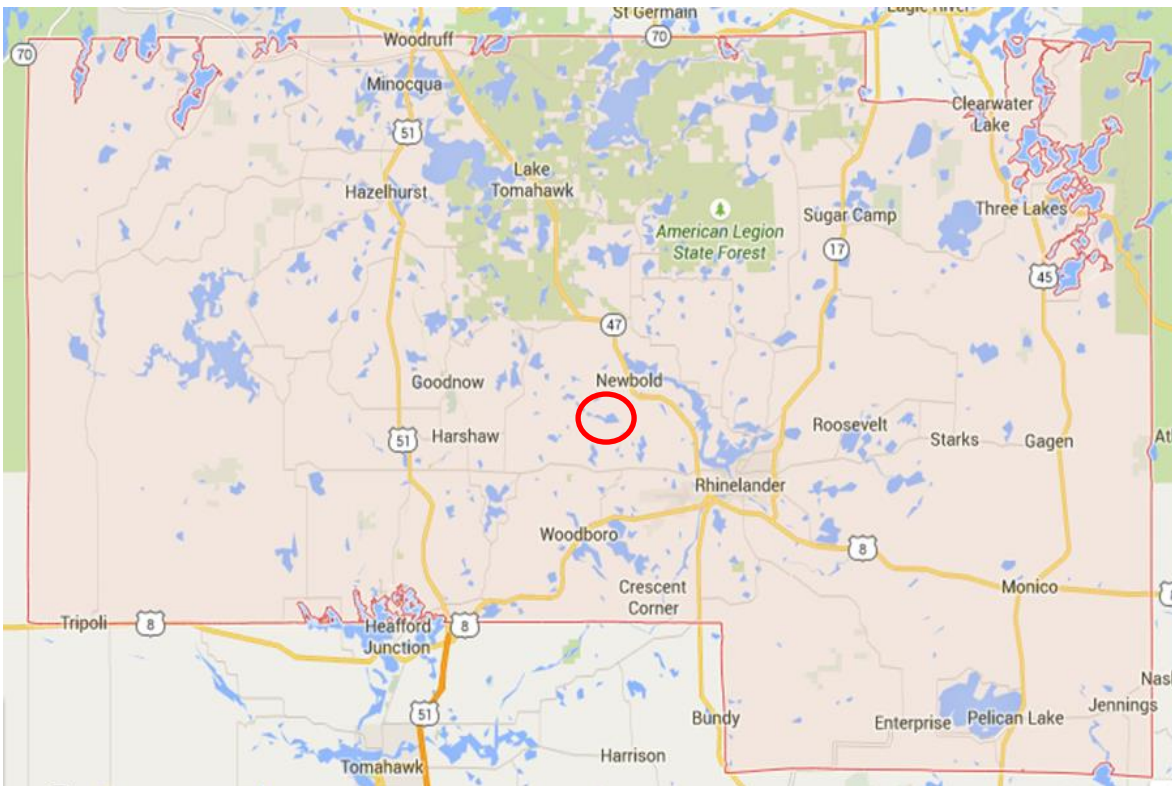

Figure 1. Map of Oneida County, WI with Mildred Lake circled.

Sheet 2 of 2

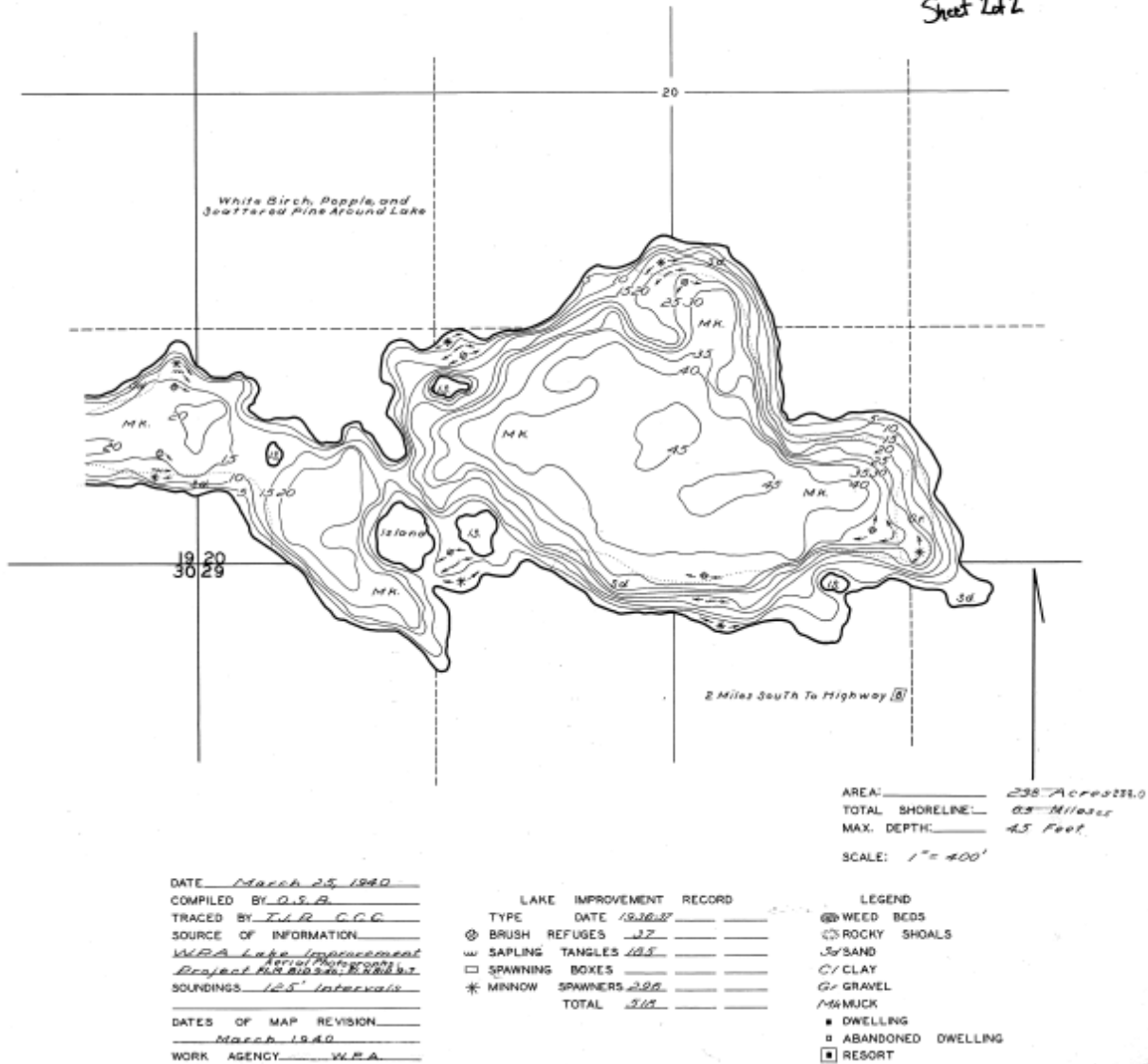

Figure 2a. Bathymetric map of the east side of Mildred Lake, Oneida County, WI.

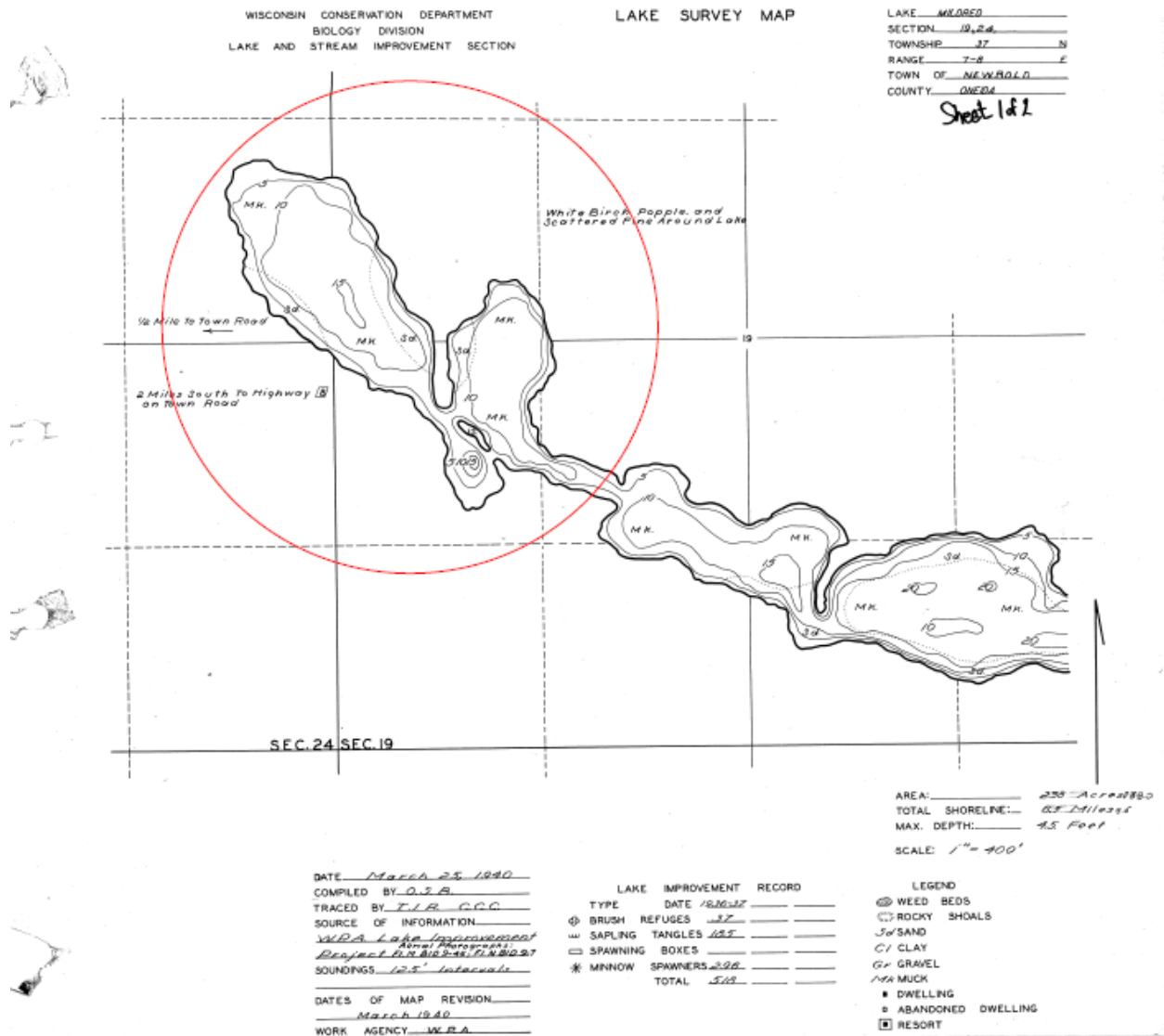

Figure 2b. Bathymetric map of the west side of Mildred Lake, Oneida County, WI. The red circled portion is Clear Lake, which is connected to Mildred Lake.

Map Source: Wisconsin Department of Natural Resources 608-266-2621, Lake Mildred – Oneida County, Wisconsin – DNR Lake Map, Date – March, 1940 – Historical Lake Map



Figure 3. Map of Mildred Lake with locations of presence/absence checks for AIS and the site where we entered the lake. The red line separates Mildred Lake from Clear Lake.

Resources: <http://dnr.wi.gov/lakes/lakepages/LakeDetail.aspx?wbic=1004600&page=facts>