

Island Lake

Page 1: AIS Monitoring and Water
 Clarity Report of July 23, 2015



Land & Water Conservation Department

*Jean Hansen, County Conservationist
Michele Sadauskas, AIS Coordinator
Jonna Stephens Jewell, Program Assistant*

Oneida County Courthouse
P O Box 400, Rhinelander, Wisconsin 54501
Phone (715) 369-7835 Fax (715) 369-6268

Island Lake AIS Monitoring and Water Clarity Report

WBIC: 1610500
Previous AIS Findings: Chinese Mystery Snail, Hybrid Cattail, Purple Loosestrife, Rusty Crayfish
New AIS Findings: Yellow Iris
Field Date: July 23, 2015
Field Crew: Stephanie Boismenu and Samantha Zommers, AIS Project Assistants, Oneida County Land and Water Conservation Department
Report By: Samantha Zommers

Stephanie and I monitored Island Lake on Thursday July 23, 2015. We went on the lake with Mark, who is one of the captains for the Three Lakes Waterfront Association. Since this lake is 305 acres, it is large for our AIS team to do by ourselves in the canoe. Due to the unavailability of the dissolved oxygen meter along with time restrictions, we were not able to obtain information on the dissolved oxygen, temperature, and the Secchi disk reading at the deep hole. Although we did not obtain deep hole readings, being up high in a boat allowed us to get a great visual search of the lakes aquatic and terrestrial plants while looking for invasive species.

Island Lake is in the municipality of Three Lakes (Figure 1). This is a drainage lake that is characterized by a bottom with 70% sand, 15% gravel, 5% rock, and 10% muck. There are many abundant fish species present such as musky, panfish, largemouth bass, smallmouth bass, northern pike, and walleye. The maximum depth in this lake is 26 feet which can be seen on the bathymetric map (Figure 2). The WDNR lists Island Lake's trophic state as eutrophic. Eutrophic lakes are characterized by an excessive amount of nutrients, allowing the lake to support an abundance of plants and algae.

We entered Island Lake through Mark's dock. Using his boat we did five in depth absence/presence checks for aquatic invasive species (Figure 3). All five checks by the department of natural resources protocol have to be done in 100 foot intervals along the shoreline while weaving in and out of the littoral zone of the lake. During monitoring we not only search these five areas, but the entire shoreline of the lake. Both private and public boat landings were inspected more intensely along with bays of high risk areas.

Findings:

Aquatic Invasive Species:

Unfortunately, on our monitoring search there were two patches of yellow iris discovered.

Dissolved Oxygen:

No data available.

Secchi:

No data available.

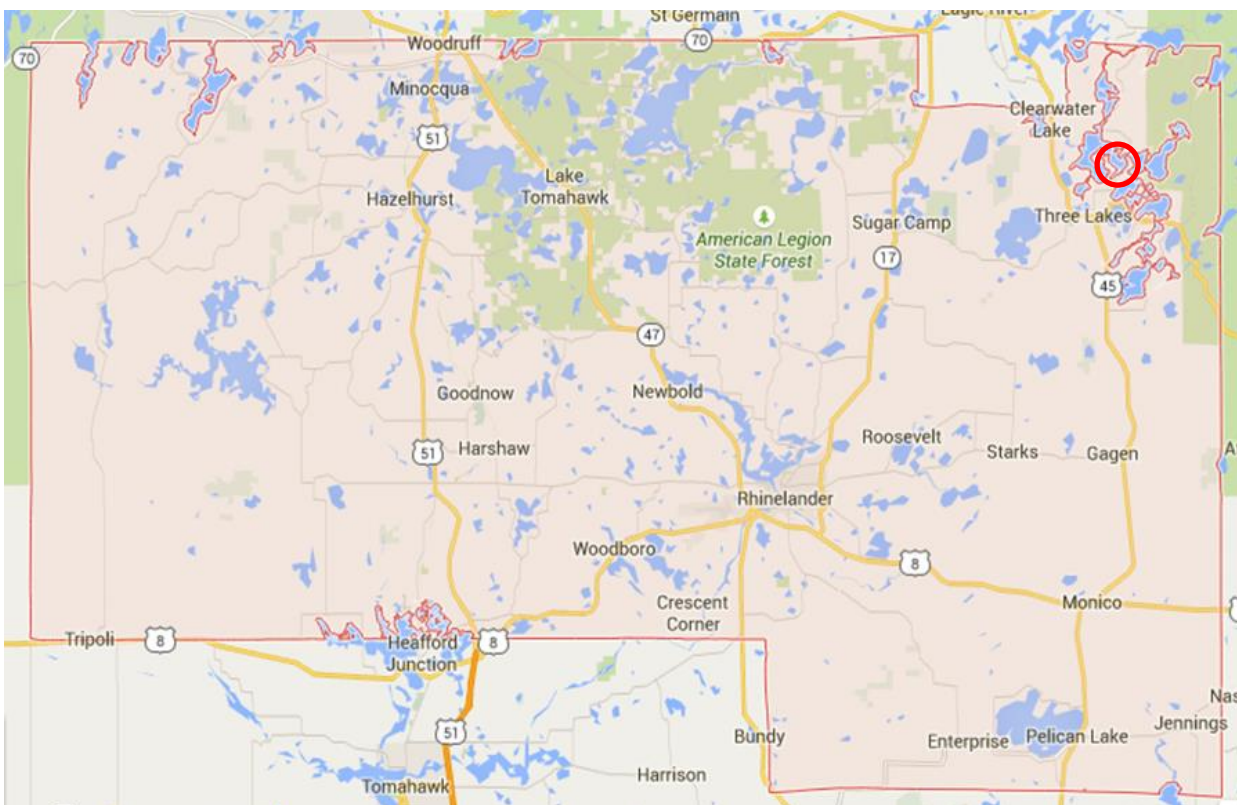

Figure 1. Map of Oneida County, WI with Island Lake circled.

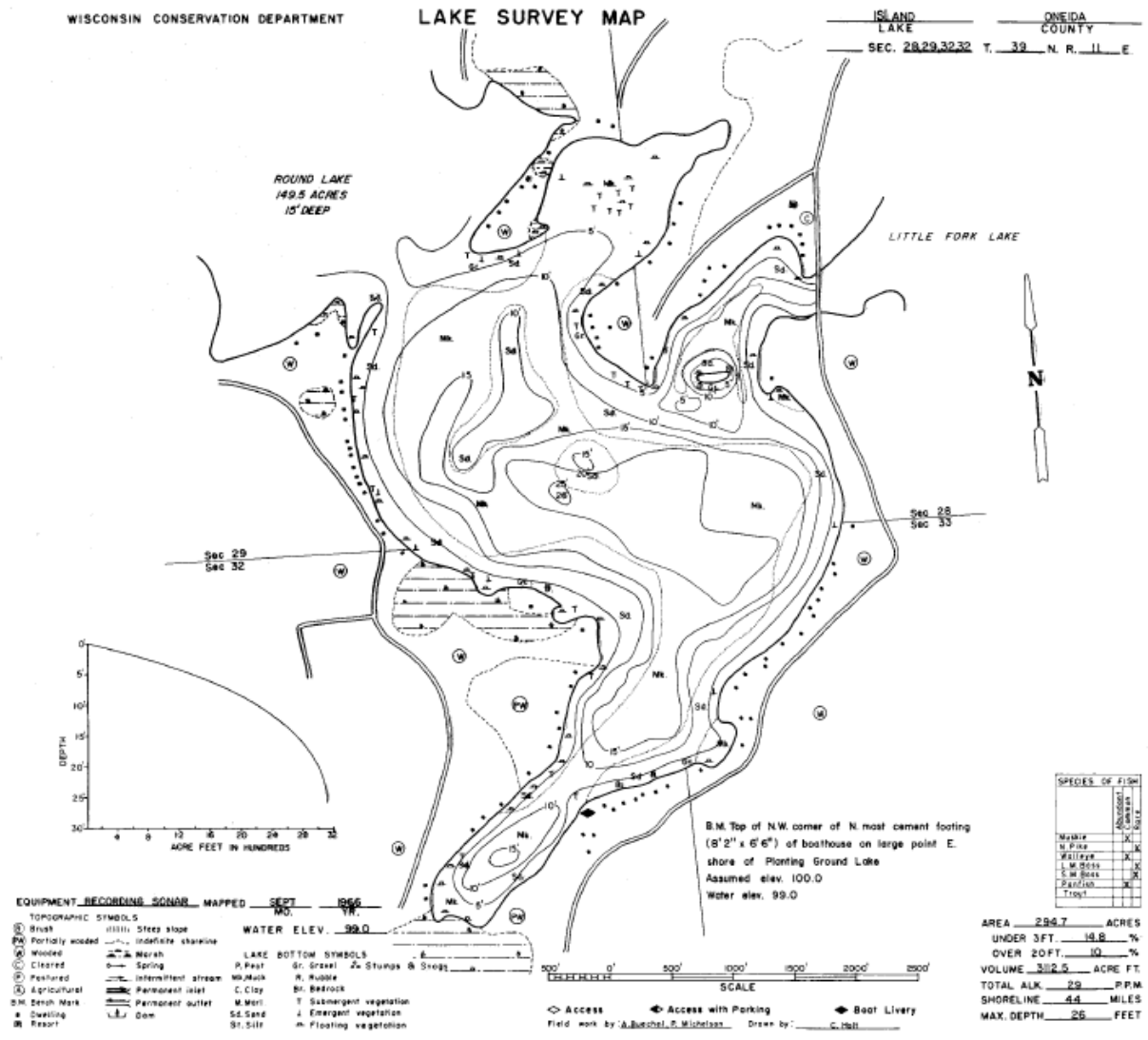

Figure 2. Bathymetric map of Island Lake in Oneida County, WI.

Map Source: Wisconsin Department of Natural Resources 608-266-2621, Island Lake – Oneida County, Wisconsin – DNR Lake Map, Date –September, 1966– Historical Lake Map

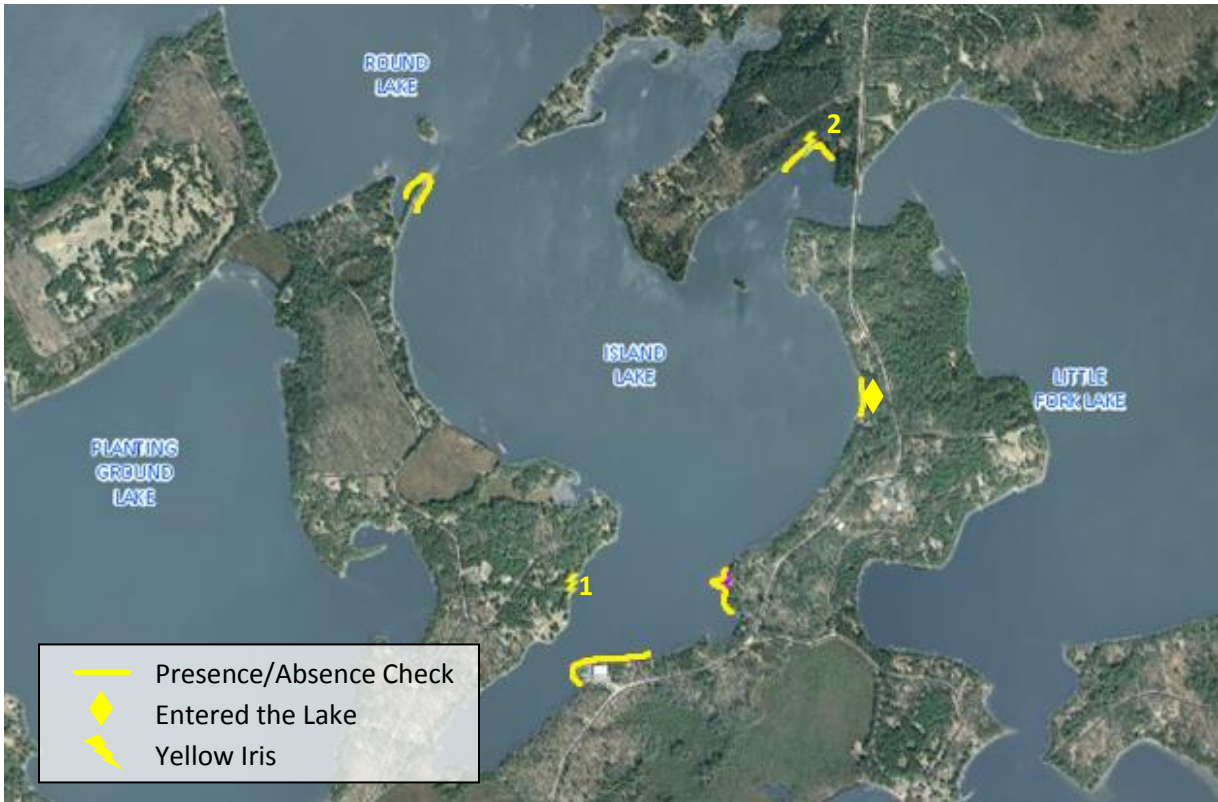

Figure 3. Map of Island Lake with the site of yellow iris one and two, locations for monitoring of aquatic invasive presence/absence checks, and the place we entered the lake using Mark’s dock.

Yellow Iris #1 GPS Coordinates: 45.823655, -89.135242

Yellow Iris #2 GPS Coordinates: 45.834206, -89.127109

Resources: <http://dnr.wi.gov/lakes/lakepages/LakeDetail.aspx?wbic=1610500&page=facts>